

SUPERCHARGE YOUR COVID RAPID TESTING PORTFOLIO WITH AQ⁺

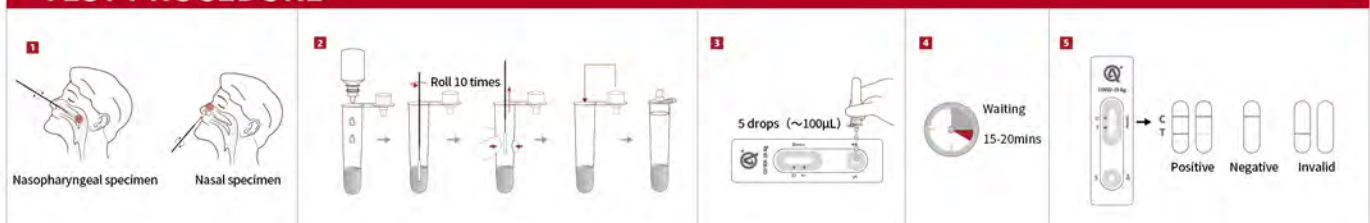

- ◆ Next-generation point-of-care immunoassay platform utilizing signal-enhancing SILICORE™ technology
- ◆ **Up to 25X increase in analytical sensitivity compared to leading rapid test brands**
- ◆ **100% sensitivity for Ct<30; 97% for Ct<36 (30% of the specimens Ct>30)^[1]**
- ◆ Positive and negative controls included for on-site QC
- ◆ Ongoing evaluations in clinical sites across Europe and APAC
- ◆ Open to strategic partnerships
- ◆ Samples available upon request

TEST PROCEDURE



AQ⁺ COVID-19 Ag RAPID TEST (NP/N)

PERFORMANCE

AQ⁺ COVID-19 Ag RAPID TEST HAS DEMONSTRATED STRONG PERFORMANCE IN CLINICAL SENSITIVITY

- A study including 300 individuals investigated the performance of the AQ⁺ COVID-19 Ag Rapid Test using a NP swab compared to Panbio™ COVID-19 Ag Rapid Test. A total of 300 symptomatic individuals with known positive (n=200) and negative (n=100) COVID-19 status using rRT-PCR were enrolled in this study. (30% of the specimens Ct>30)^[1]

		rRT-PCR (ORF1ab)	
		Positive	Negative
AQ ⁺ COVID-19 Ag Rapid Test	Positive	194	0
	Negative	6	100
	Total	200	100
Sensitivity		97.0% (95% CI: 93.6% to 98.9%)	
Specificity		100.0% (95% CI: 96.4% to 100.0%)	
Accuracy		98.0% (95% CI: 95.7% to 99.3%)	

Sensitivity Comparison AQ⁺ 97.0% vs Panbio™ 64.0%

Real time RT-PCR (ORF1ab)		AQ ⁺ COVID-19 Ag Rapid Test		Panbio™ COVID-19 Ag Rapid Test	
	Positive	Positive	Sensitivity (95% CI)	Positive	Sensitivity (95% CI)
Ct ≤ 30	140	139	99.3 (96.1 to 100.0)	106	75.7 (67.8 to 82.6)
30 < Ct ≤ 36	60	55	92.3 (83.0 to 97.5)	22	36.7 (24.6 to 50.1)
Overall	200	194	97.0 (93.6 to 98.9)	128	64.0 (56.9 to 70.7)

ORDERING INFORMATION

Product	Cat. No.	Format	Pack Size	Specimen*	Certification
AQ ⁺ COVID-19 Ag Rapid Test	ITP16042	Cassette	25T	NP+N swab	CE
AQ ⁺ COVID-19 Ag Rapid Test (with negative and positive control)	ITP16044	Cassette	25T	NP+N swab	CE

*Specimen: NP=Nasopharyngeal, N=Nasal

[1] Evaluation of high sensitive AQ⁺ COVID-19 Ag Rapid Test (nasopharyngeal specimen): Comparison with Real-time RT PCR. *Virology Laboratory, Infectious Diseases Division (IDD) icddr, b, Dhaka, Bangladesh. Reporting date: 4 November 2021*

InTec PRODUCTS, INC.

332 Xinguang Road, Xinyang Industrial Area, Haicang, 361022, Xiamen, Fujian, P.R.China

+86 592 6807188

+86 592 6519161

www.intecasi.com

E-mail: intecproducts@asintec.com

