

# 血型二代自测快速操作指南

尺寸:297x210mm

材质:70g双胶纸

工艺:单面彩印

01.05.14.129-221204

■ C:10M:100Y:80K:25

■ C:0M:0Y:0K:100

**InTec** InTec PRODUCTS, INC.

## ABO&RhD Blood Grouping Kit QUICK OPERATION GUIDE

**CAUTION:** Study the instructions for use before using Quick operation guide. This is not complete Instructions for use. After looking at the diagram below and familiarizing yourself with how to use it, follow the guide below.

### STEP 1 PREPARATION

**1.** Wash your hands and make sure they are dry before starting the test.



**2.** Open the package box. Look for the following components provided:

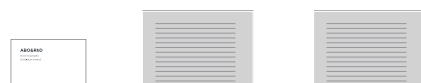

Test cassette Instructions for use Quick operation guide

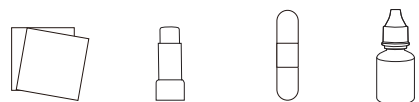

Alcohol swab Safety lancet Band-Aid Sample diluent

**CAUTION:** Carefully read the instructions for use prior to use ABO&RhD Blood Grouping Kit

**3.** Check the expiry date on the foil pouch. Do not use the kit if expiry date has passed. Unseal the pouch and place the card on a clean and dry surface.

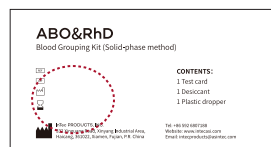

Use when equilibrated to room temperature (10-30°C)

**4.** Unseal the foil pouch. Put the card and dropper on a clean, dry and level surface.

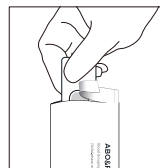

### STEP 2 SAMPLE COLLECTION

**5.** Clean the finger with alcohol swab and leave it to dry.

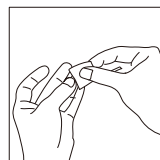

**6.** Twist the lancet cap for over 180° and remove it.

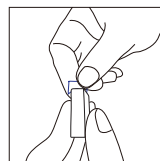

**7.** Place the lancet firmly on side of finger (avoid callus) to trigger it.

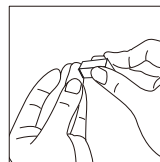

### STEP 3 ADD SAMPLE

**8.** Use dropper to collect sample. Gently squeeze and release bulb to collect blood past tip of dropper.

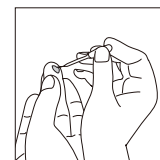

**9.** Add 1 drop (10 ~ 15µL) of sample using the provided dropper onto the sample pad center. Wait for 10-30 secs.

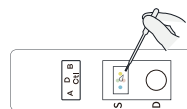

### STEP 4 ADD SAMPLE DILUENT

**10.** Unscrew the lid of the buffer bottle.

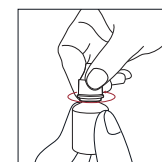

**11.** Add 4 drops (~ 140µL) of the sample diluent to the diluent pad.



### STEP 5 RESULT INTERPRET

**12.** Wait for at least 2mins (Interpret and record the results within 15mins).



#### POSITIVE

Immune binding reaction occurs between RBC antigen to be detected and corresponding solid blood group antibody, and red dots are shown at the corresponding detection points and Ctl point, indicating a positive reaction. Red dots appear at both detection and Ctl region (even very weak) indicates a positive result.

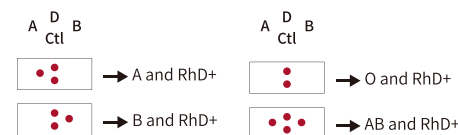

#### NEGATIVE

No immune binding reaction occurs between the RBC antigen to be detected and the solid blood group antibody, no RBC is captured, red blood cells are completely rinsed out, and a red dot is shown at Ctl point, indicating a negative reaction.

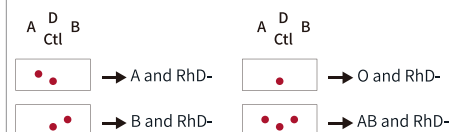

#### INVALID

Regardless of whether red dots are displayed at points A, B and D, if the red dot is not displayed at Ctl point, the test result is invalid.

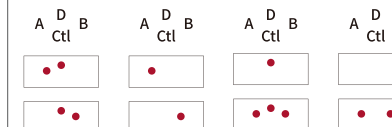

#### Positive control

After detection, the red Ctl point in the sample pad were positive control.

**CAUTION:** Please refer to the INSTRUCTIONS FOR USE for more details.

InTec PRODUCTS, INC.  
332 Xinguang Road, Xinyang Industrial Area,  
Haicang, 361022, Xiamen, Fujian, P.R. China

Tel: +86 592 6807188  
Website: www.intecasi.com  
Email: intecproducts@asintec.com